

## Drives and Housing Positions

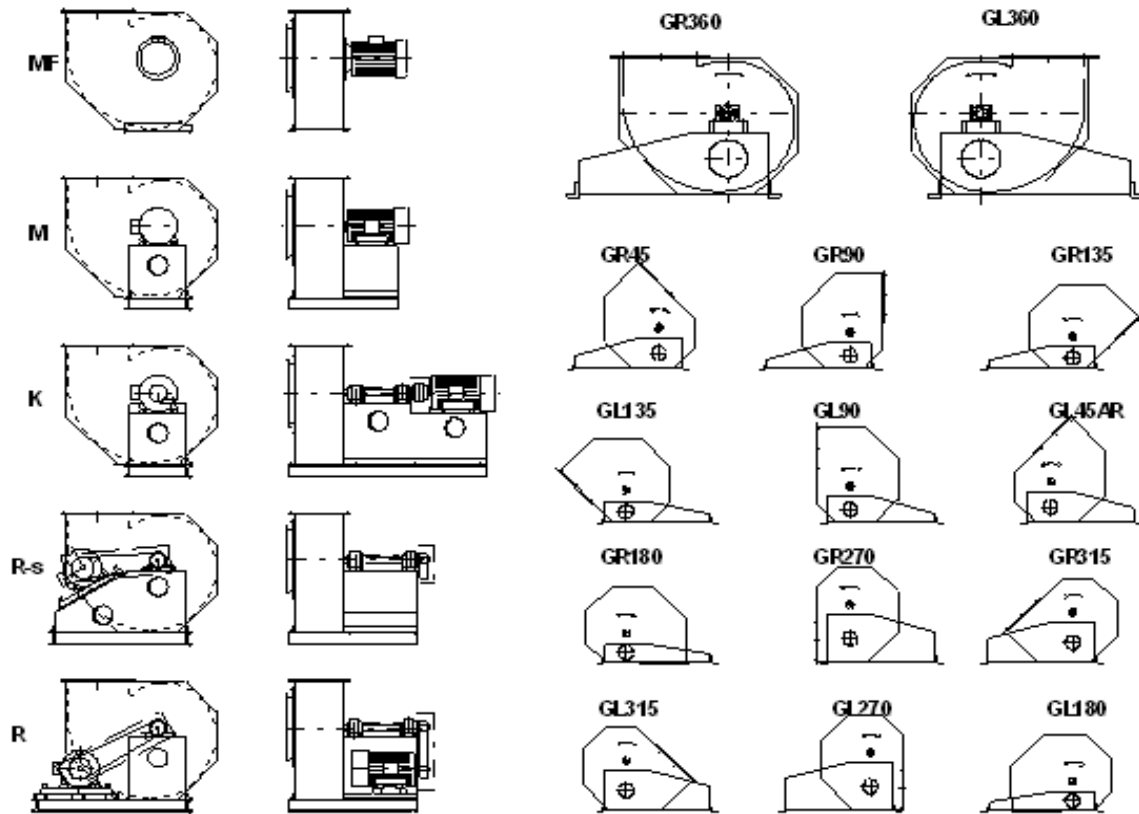

standards designation: z.B.: HNN a ex / R U 500 M GR360

1 | 2 | 3 | 4 | 5 | 6 | 7 | 8

- 1 = type designation (U-...: circulator without spiral housing)  
 2 = abnormal impeller: z.B. intermediate blades, b < normal, D2 < or > normal  
 3 = ex-protection  
 4 = construction: R = radial with single inlet, Z = radial with double inlet, A = axial  
 5 = connection type: U = direct tube connection, E = inlet nozzle, S = suction box  
 6 = rated quantities graded according to row of preferred number R20  
 7 = drive:  
     MF = direct drive with flange motor  
     M = direct drive with B3-motor on welded support  
     K = direct drive by means of an elastic coupling  
     KG = direct drive by means of a coupling or gearing  
     R-s = belt drive, motor on beveled frame  
     R = belt drive, motor on base frame  
 8 = housing position: GR = right-handed, GL = left-handed

## Flanges

All suction-sided flanges correspond to DIN 24154, part 2, row 2 and are made according to the dimensions comprised in the following schedule. If a series also has a round outlet on the pressure side, the following dimensions can be taken for the pressure-sided flanges, too. If there is a rectangular outlet, you will find the corresponding flange dimensions under the respective series within the sheets with dimensions and characteristic curves.

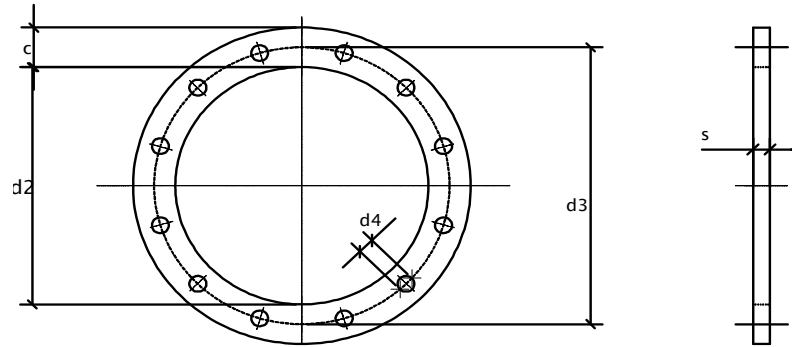

nominal size	inside $\varnothing$ d2		breadth x thickness c x s	hole circle- $\varnothing$ d3 + 0,5	hole- $\varnothing$ d4 + 0,5	number of holes	screws		
		maximal deviation							
71	73	+ 1 0	30x6	110	10	4	M8		
80	82								
90	92								
100	102								
112	114								
125	127								
140	142	+ 1,5 0	35x6	182	12	8	M10		
160	162								
180	182								
200	203								
224	227								
250	253								
280	283								
315	318		40x6	332					
355	358								
400	404								
450	454								
500	504								
560	564	+ 2 0	50x8	629	14	16	M12		
630	634								
710	714								
800	804								
900	904								
1000	1005								
1120	1125		60x10	1200		18,5		32	M16
1250	1255								
1400	1405								
1600	1605								
1800	1805								
2000	2005								
				2037					

s and d4 deviate from DIN.

All information in mm!

---

The Venttek-High-Efficiency-Fan Program furthermore contains:

- Industrial fans in radial construction
- Smoke gas fans
- Multiple stage fans
- Pressure and shock resistant fans
- High pressure fans
- Hot gas fans
- Built-in fans without casing
- Portable fans in radial and axial design in explosion proof construction for zone I and II

We would be pleased to give you further information.



Central Office : ÇobançeŐme Mahallesi, Sanayi Caddesi  
Genç Osman Sokak, No.16  
Yenibosna / İstanbul / Türkiye  
Tel : ( 0212 ) 551 1112  
Fax : ( 0212 ) 654 2776

Factory : AŐađı Sevindikli Ky Yolu Üzeri  
Muratlı / Tekirdađ / Türkiye  
Tel : ( 0282 ) 373 7088  
Fax : ( 0282 ) 373 7087

e-Mail : [info@venttek.com](mailto:info@venttek.com)  
[www.venttek.com](http://www.venttek.com)

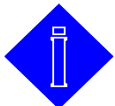

**İNCİRCİOĐLU**<sup>®</sup>  
Vantilatr, Klima İmalat San. ve Tic. Ltd. Őti.

